

CR1025

3V Lithium Battery
Swiss Made

Technical Data Sheet

Specifications

Chemical System	Li / MnO ₂
Nominal Voltage	3 V
Rated Capacity	30 mAh
Standard Discharge Current	0.05 mA
Max. Cont. Discharge Current**	0.4 mA
Average Weight	~ 0.6 g
Operating Temperature*	-40 - +85 °C
Self Discharge at 23°C	< 1% / year

Dimensions

(According to IEC 60086)

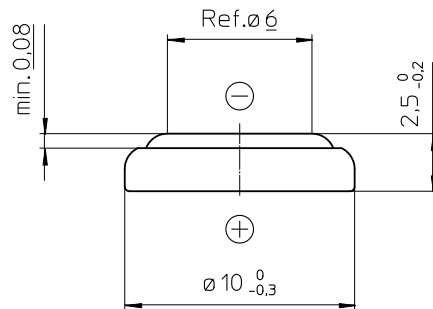

Performance

Discharge performance at 23°C

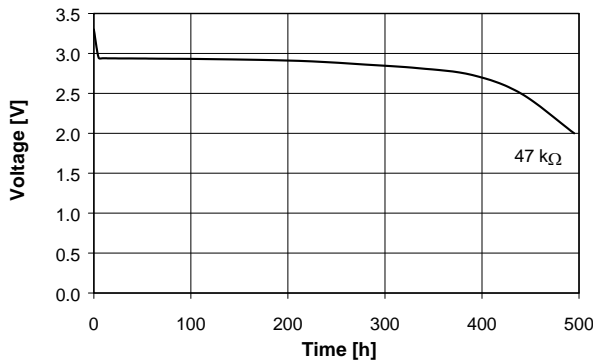

Discharge performance at 23°C

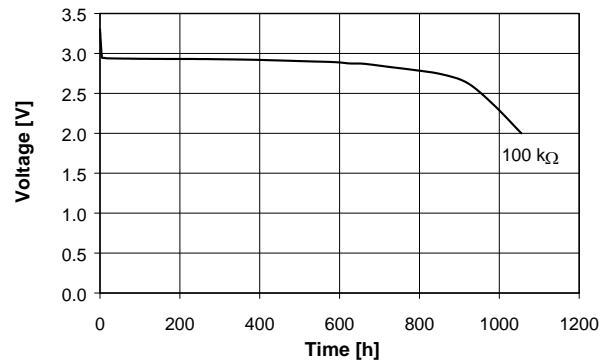

Temperature performance Load 47kΩ

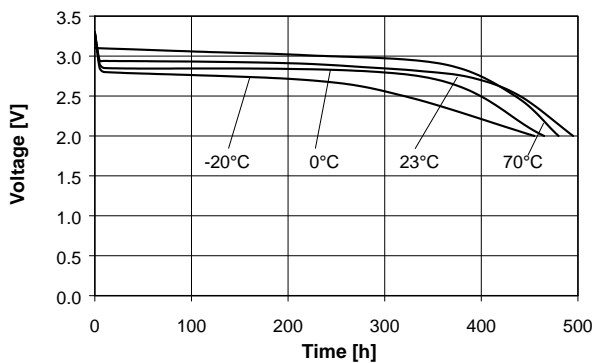

Cell capacity at various loads

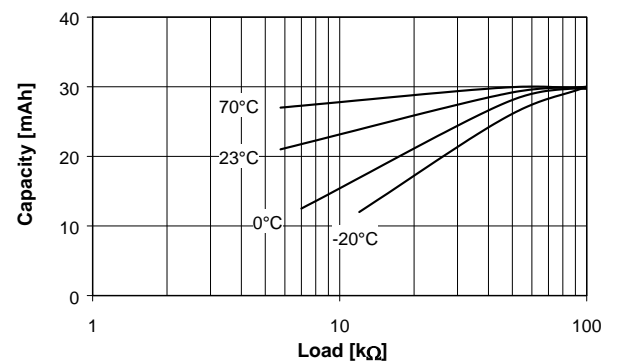

*In applications where the battery is exposed to temperatures above 70 °C, please contact Renata for consultancy.