

CR2025 MFR

3V Lithium Battery

Technical Data Sheet

Specifications

| | |
|--------------------------------|-----------------------|
| Chemical System | Li / MnO ₂ |
| Nominal Voltage | 3 V |
| Rated Capacity | 165 mAh |
| Standard Discharge Current | 0.3 mA |
| Max. Cont. Discharge Current** | 3.0 mA |
| Average Weight | ~ 2.5 g |
| Temperature Range | -30 - +70 °C * |
| Self Discharge at 23°C | < 1% / year |

Dimensions

(According to IEC 60086)

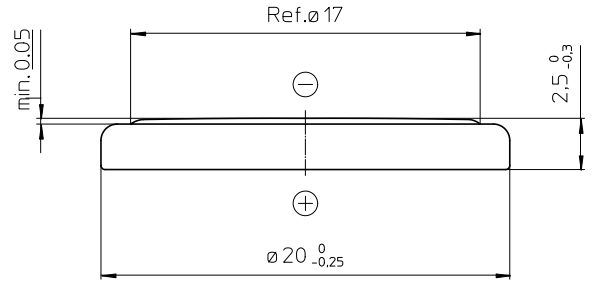

Performance

Discharge performance at 23°C

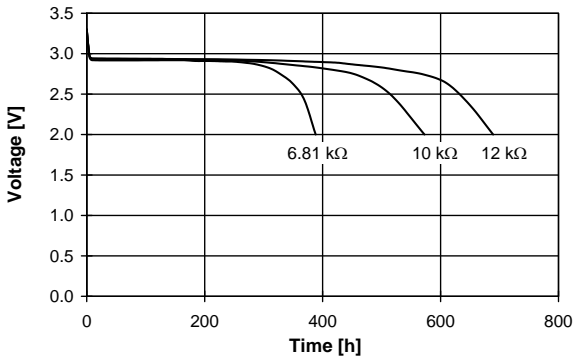

Discharge performance at 23°C

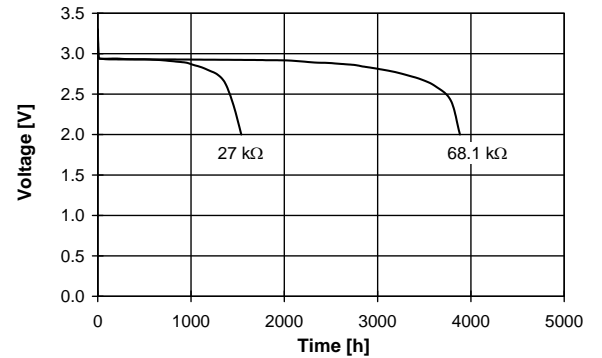

Temperature performance Load 12kΩ

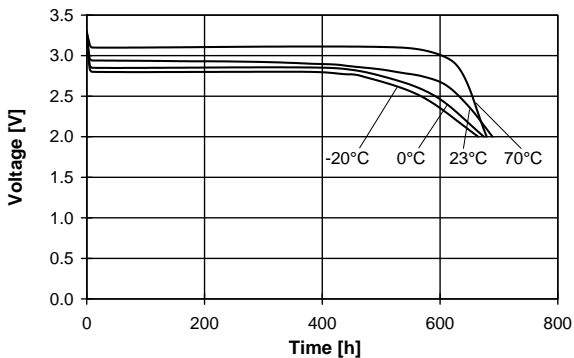

Cell capacity at various loads

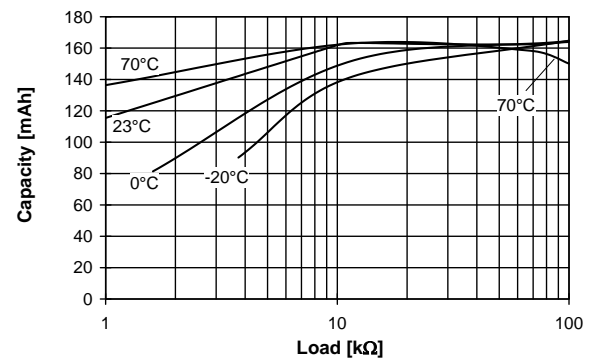

*In applications where the battery is exposed to temperatures above 60 °C, please contact Renata for consultancy.

**Average discharge current for a yield of 70% of the nominal capacity with cut-off voltage of 2.0V at 23°C.