

# CR2032 MFR

3V Lithium Battery

## Technical Data Sheet

### Specifications

Chemical System	Li / MnO <sub>2</sub>
Nominal Voltage	3 V
Rated Capacity	225 mAh
Standard Discharge Current	0.4 mA
Max. Cont. Discharge Current**	3.0 mA
Average Weight	~ 2.8 g
Temperature Range*	-30 - +70 °C *
Self Discharge at 23°C	< 1% / year

### Dimensions

(According to IEC 60086)

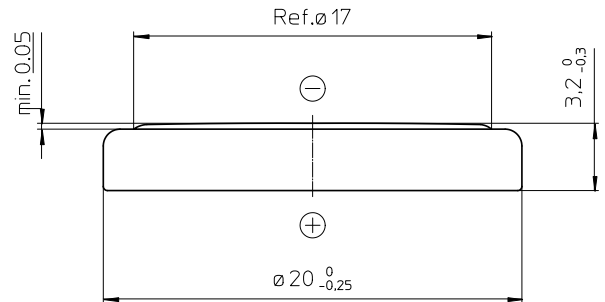

### Performance

Discharge performance at 23°C

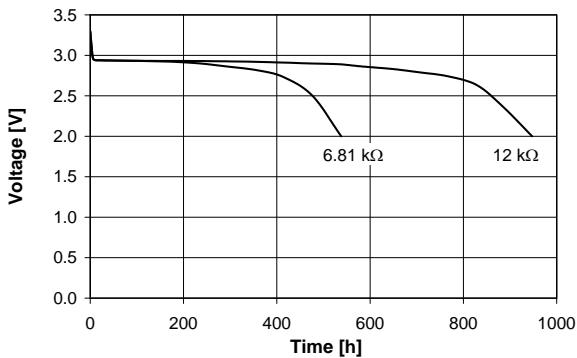

Discharge performance at 23°C

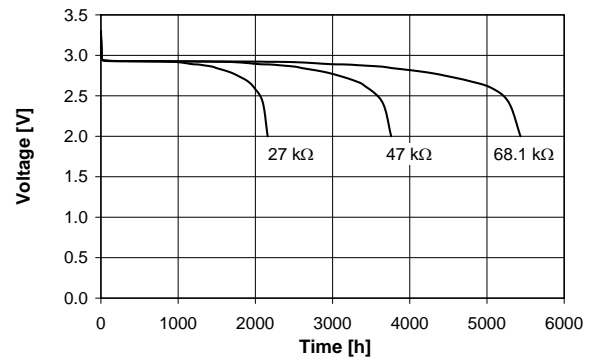

Temperature performance Load 12kΩ

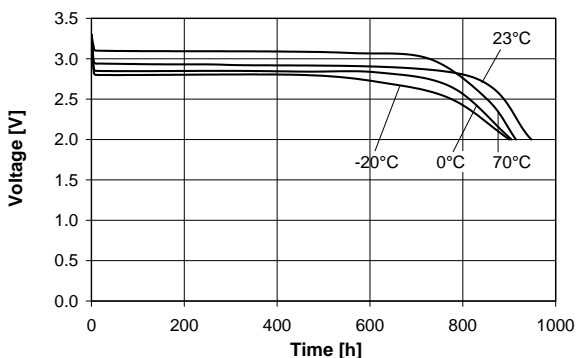

Cell capacity at various loads

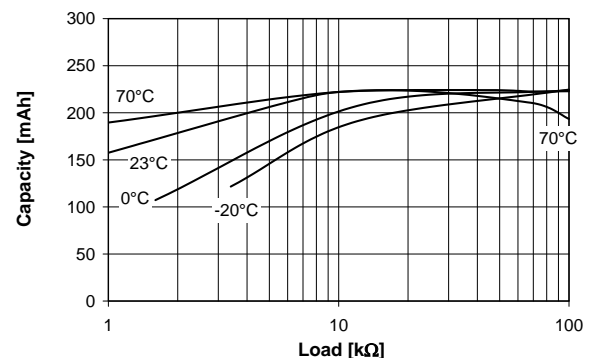

\*In applications where the battery is exposed to temperatures above 60 °C, please contact Renata for consultancy.  
\*\*Average discharge current for a yield of 70% of the nominal capacity with cut-off voltage of 2.0V at 23°C.